

SQUAT STAND PULL UP STATION

SKU: SQSTPUS02

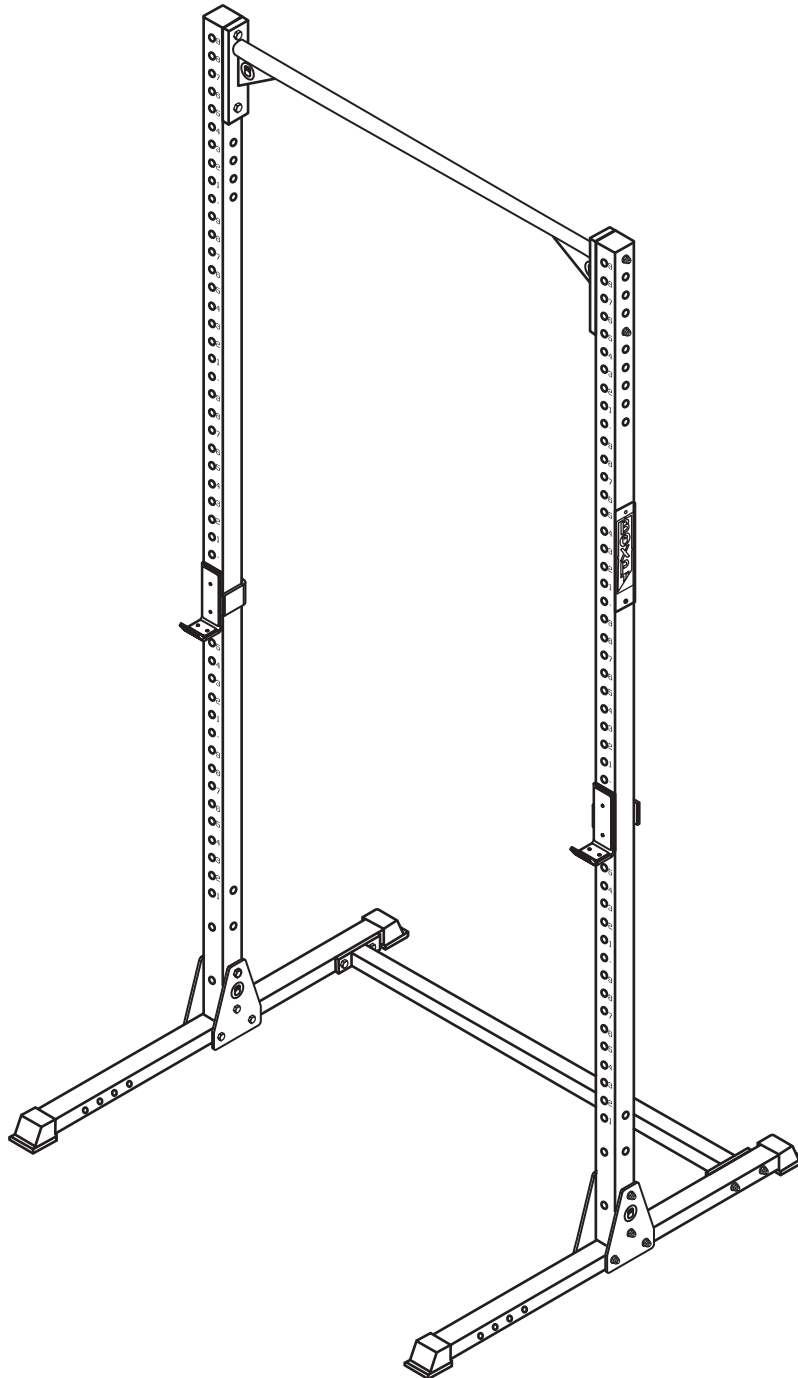

BOXPT[®]
EQUIPMENT

DISCLAIMER

This equipment must be used by competent and responsible persons or under the guidance and supervision of competent persons. Misuse of this equipment can cause damage, injury or death. The user assumes all risk and liability for incorrect use of the equipment. This equipment is intended for indoor use only. BOXPT Equipment is not responsible for any injury or damage caused by misuse.

WARNING LABELS



PREPARATION

You need the following tools to assemble the equipment.
Do not use electric power tools for assembly.

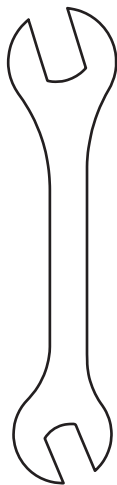

Wrench

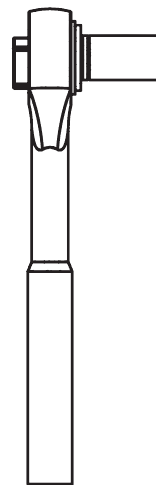

Socket Wrench

NOTE: These tools are not included.

LIST OF COMPONENTS

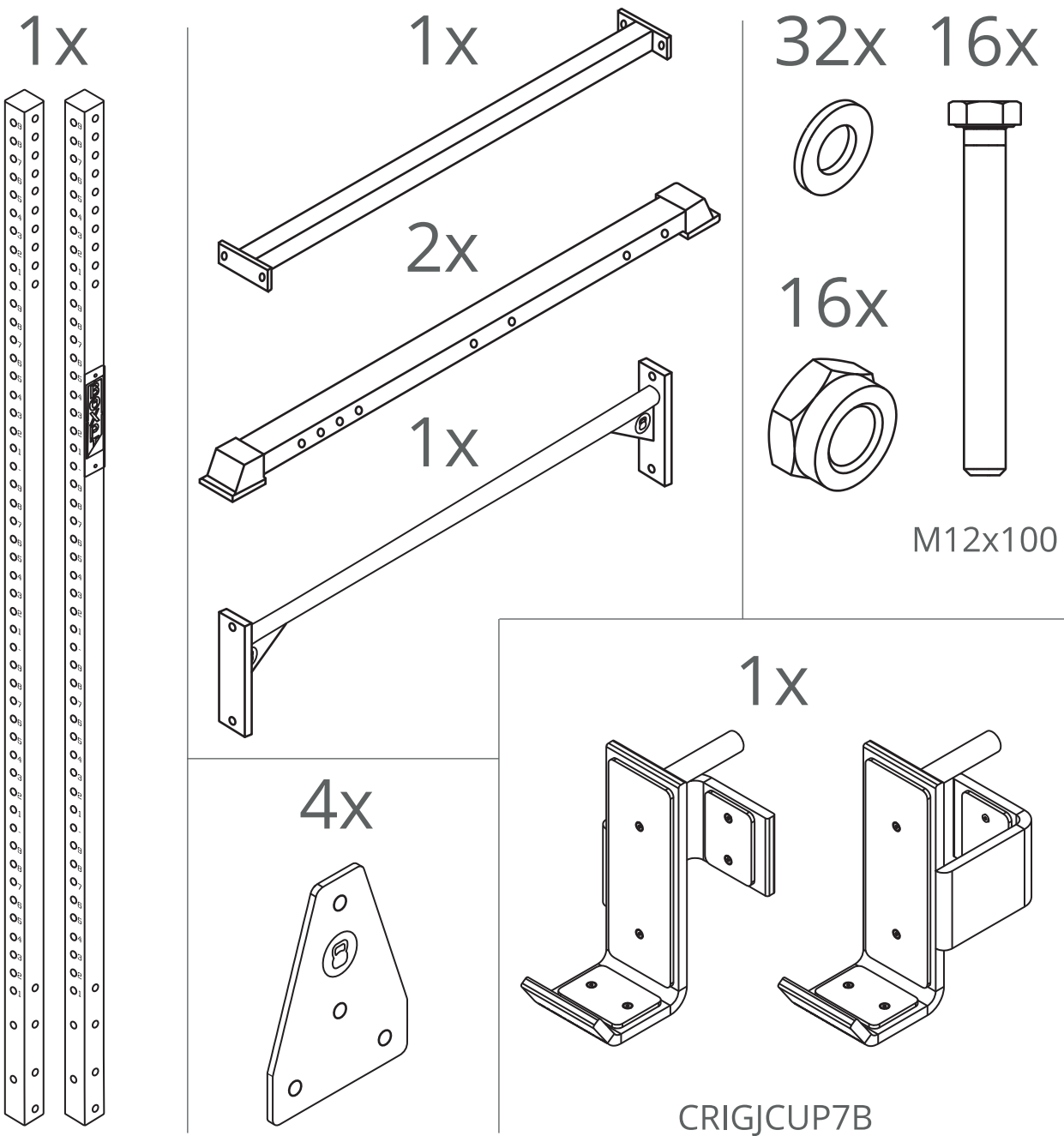

STOP

If you are missing any parts, or otherwise have any warranty issues, please contact our customer service.

1.

2x

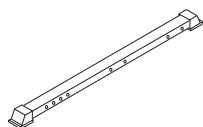

1x

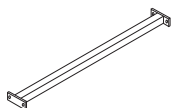

4x



8x



4x

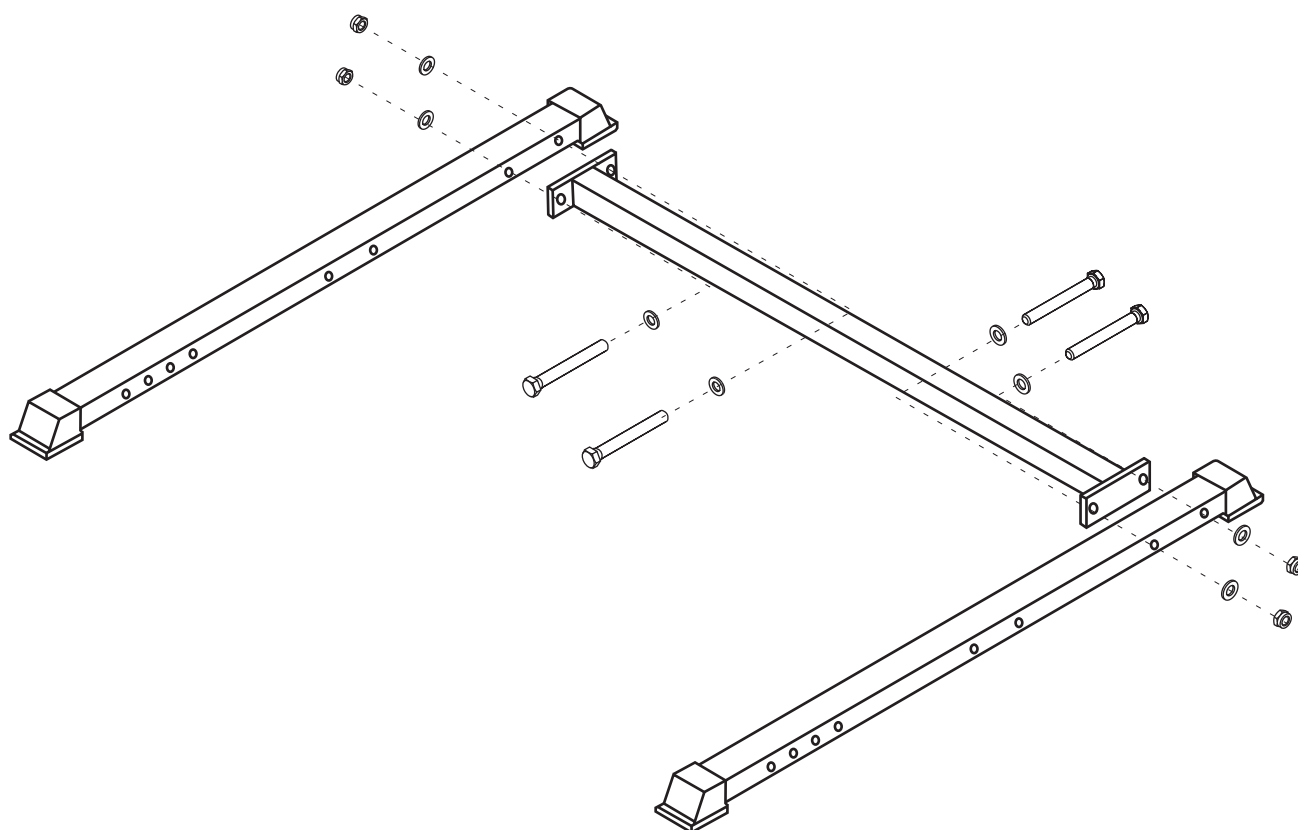
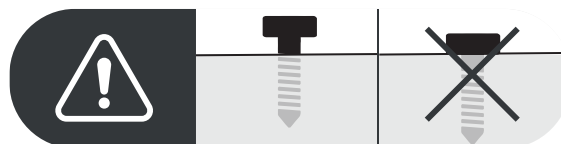
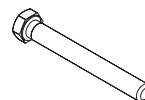

2.

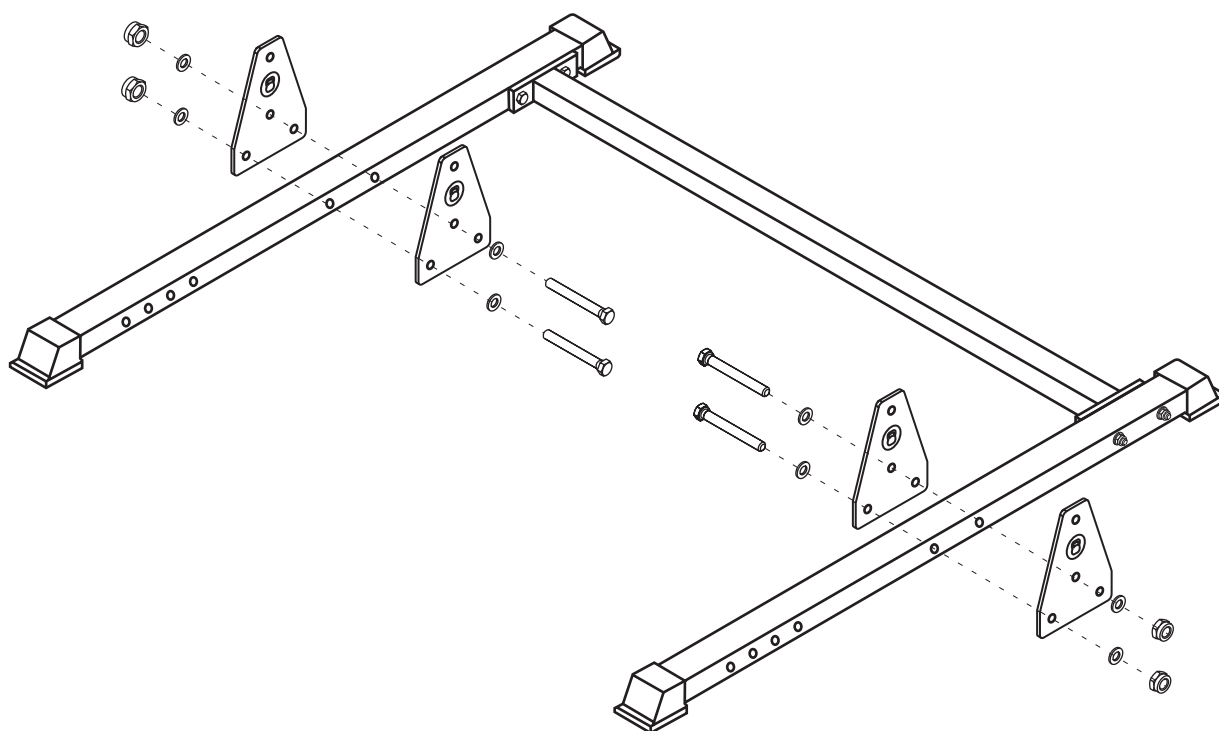
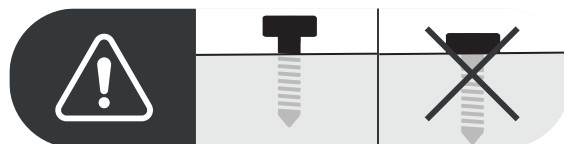
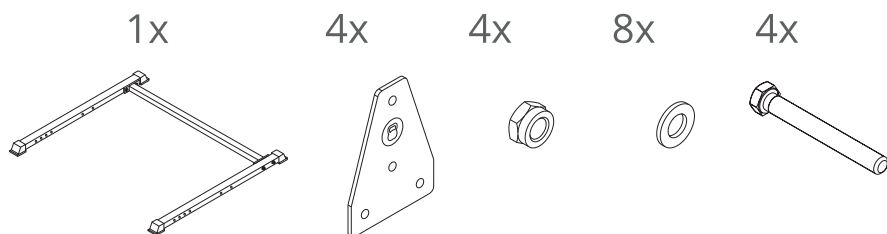

3.

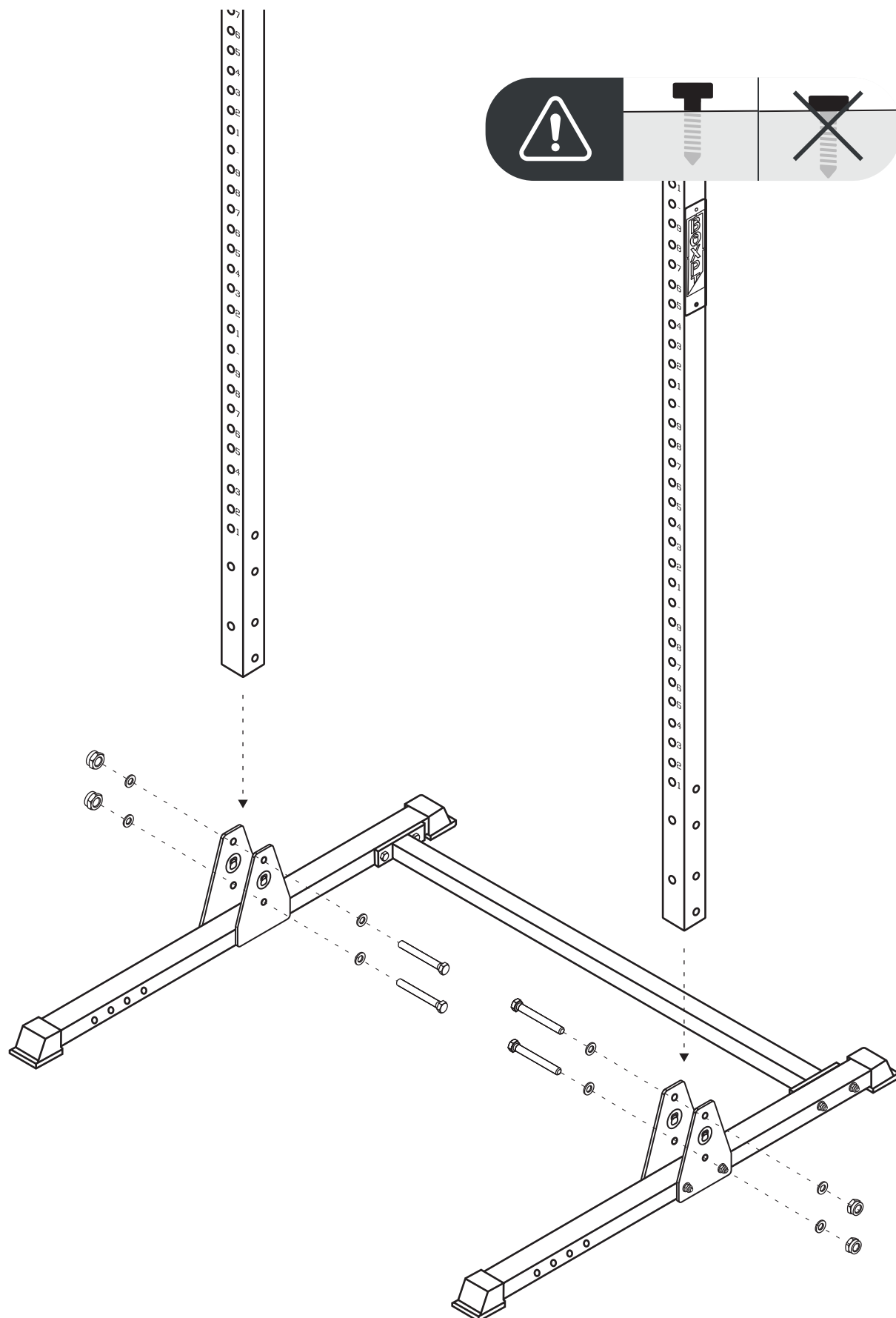
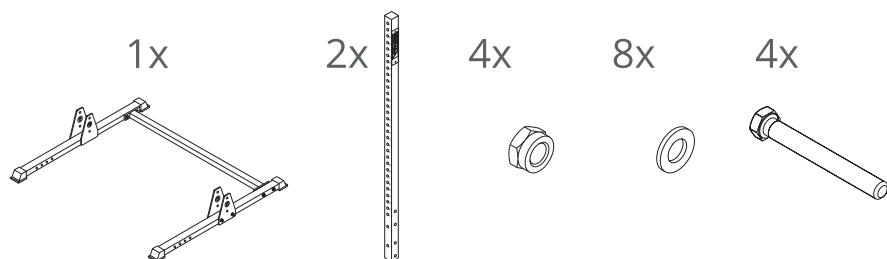

4.

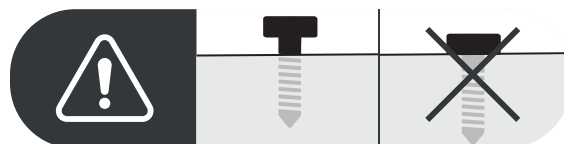
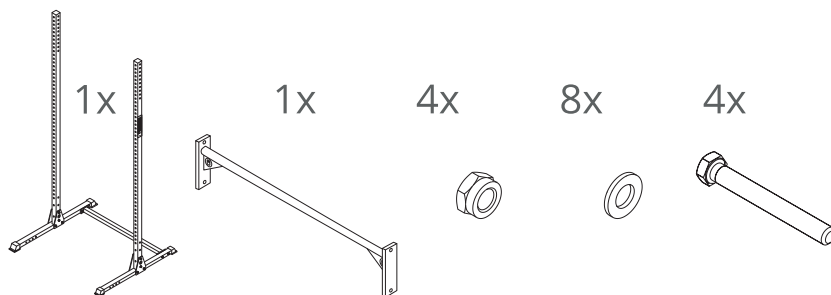

NOTE: The height of the pull up bar can be set to the height you want within the possible hole.

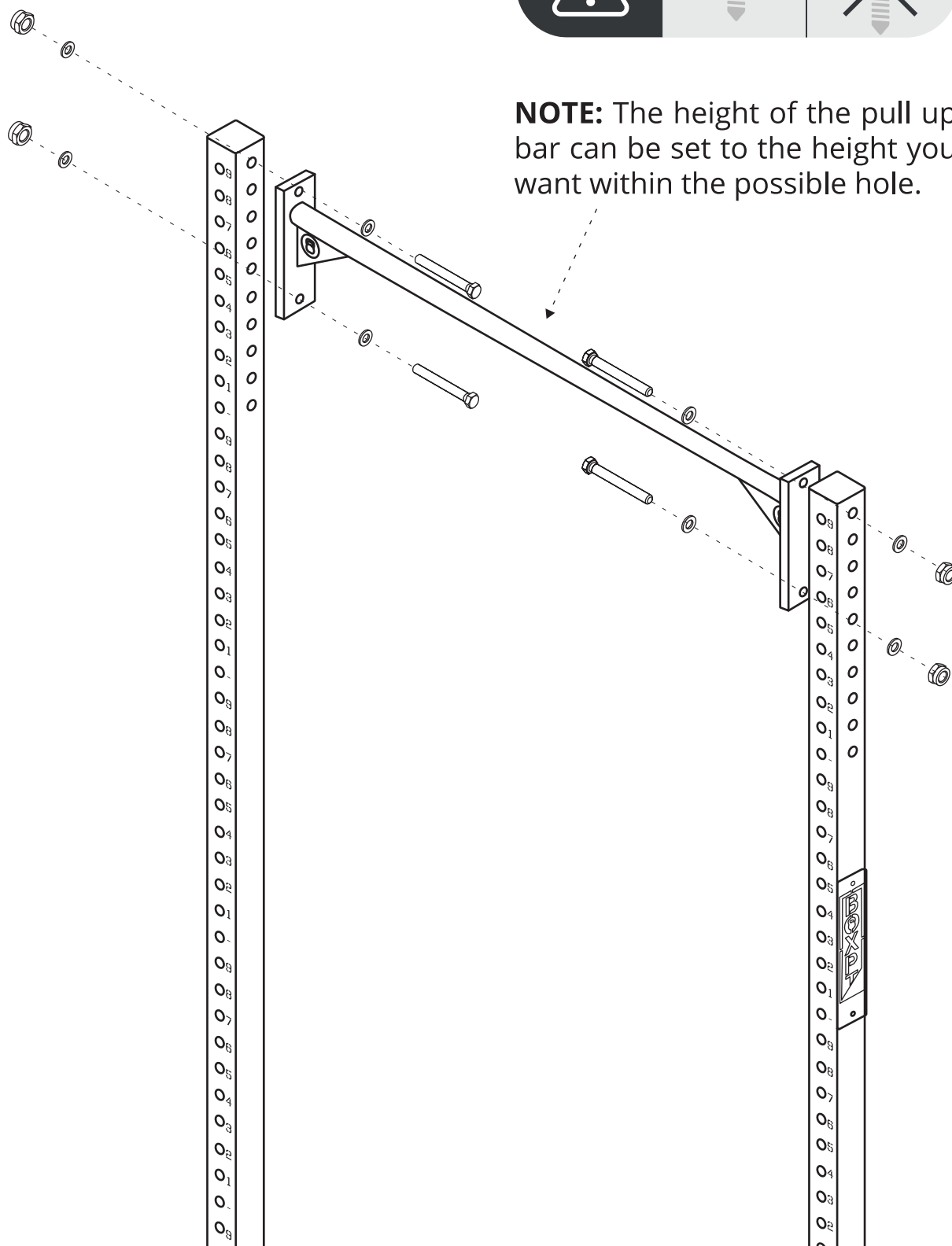

5.

